

Junction Park and the BFRT



Design Ideas for Short-term Implementation Strategy

September 8, 2022

Contents

- ▶ Existing conditions - plan and photos
- ▶ Short-term solution - plan
- ▶ Signs along the way
- ▶ Entry elements and planters - options
- ▶ Visual screens - options
- ▶ Painted pavement for the borders at entry locations

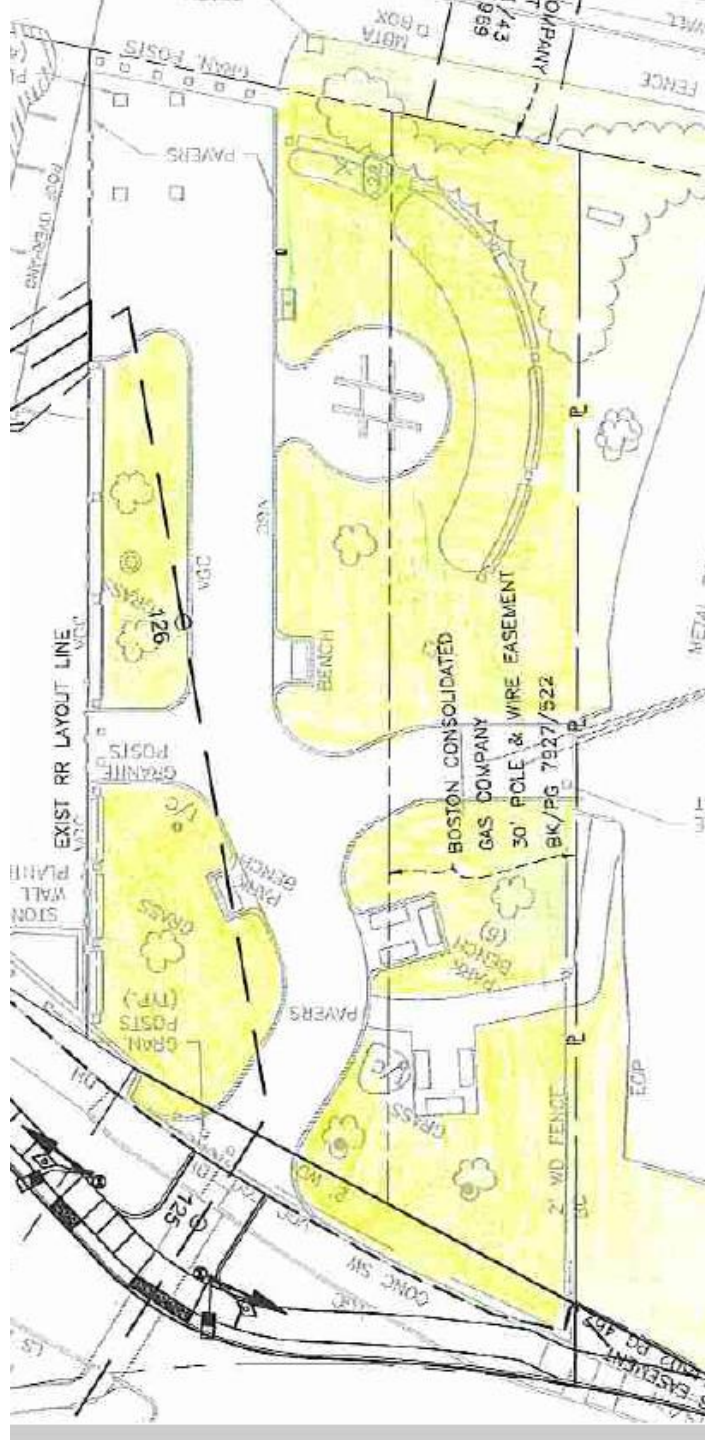

Junction Park “As-Built”

- ▶ Short term concept will keep existing layout
- ▶ Long-term concept will change the existing layout

Junction Park “As-Built”



- ▶ Short term concept will keep existing layout
- ▶ Long-term concepts will change the existing layout



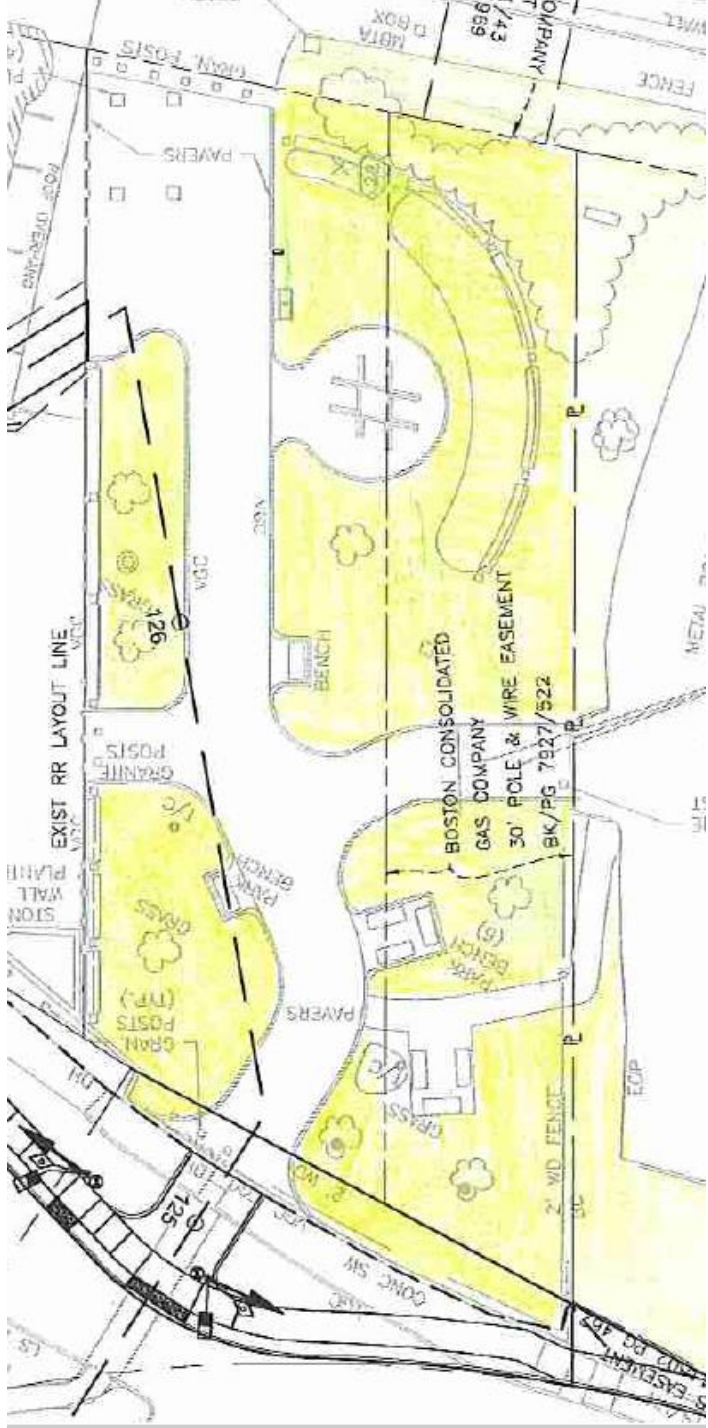

Short term (JP #10) - The personal accountability model with signifiers

- ▶ Add two signs - where trail meets the park at Club Car Café and at Main Street entrance - to welcome people to Junction Park; inviting people to use caution and respect others using the park.
- ▶ Install small wood or metal planters with an obelisk or arch and plants at afore-mentioned entrances to define the Junction Park space as different from the rail trail.
- ▶ Install 3 wood or metal planters with trellis and plants near railroad platform to visually screen the parking lot and train.
- ▶ Add two small planting beds of hosta and heuchera adjacent to the path to visually narrow the path through the park.
- ▶ Add a colorful border or 'rug' on the pavement at three entrances (Club Car Café, Main Street and Railroad Platform) to signify that people are entering a special place.
- ▶ Remove the two existing (and too small) "walk your bike" signs from the park.

Wayfinding signs for the BFRT

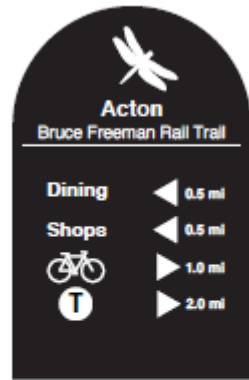

30" wide by 90" tall

**Welcome to
Junction Park
Please slow
your
Pace in this
Special Place.**

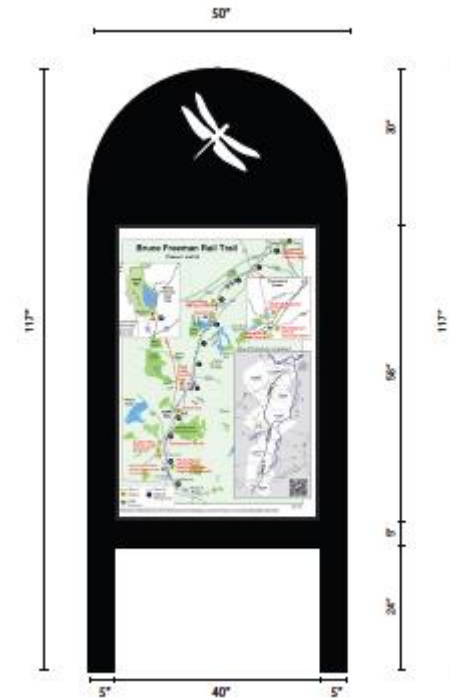

50" wide by 117" tall

Entry and Planter options

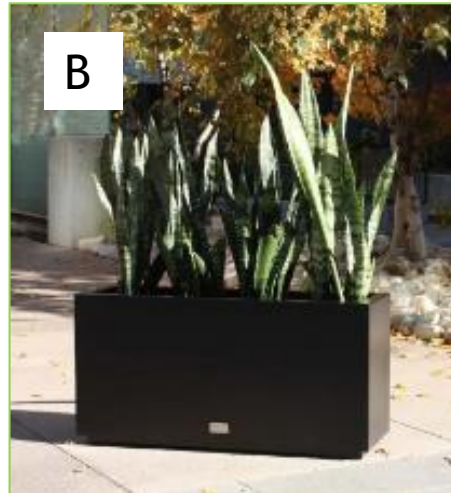

Planters with trellis or screens - wood or metal; plants can be added.

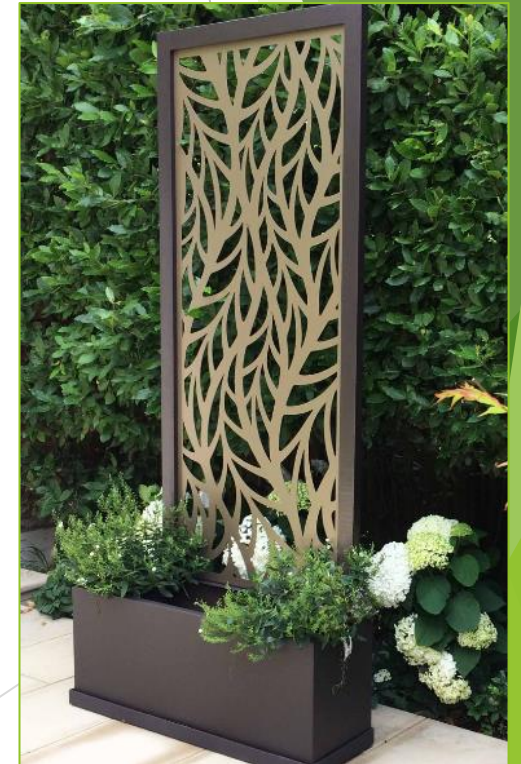

Paint the pavement at the park edges



